

Structural Cavity Batten - Fixing to Framing

Case No	Batten Orientation	Batten Size	Max. Batten Spacing (Stud Centers)	Wind Zone (per NZS3604)	Fixing Tension Required
1	Horizontal	JSC-H 45x45mm	400mm	Up to Very High Extra High	0.5 kN 0.6 kN
2	Horizontal	JSC-H 45x70mm	600mm	Up to Very High Extra High	0.7 kN 0.9 kN
3	Vertical	JSC-V 45x45mm	600mm	Up to Very High Extra High	1.8 kN per m 2.2 kN per m

Horizontal Orientation for Vertical Weatherboard Cladding

1. JSC-H 45x45mm Cavity Batten

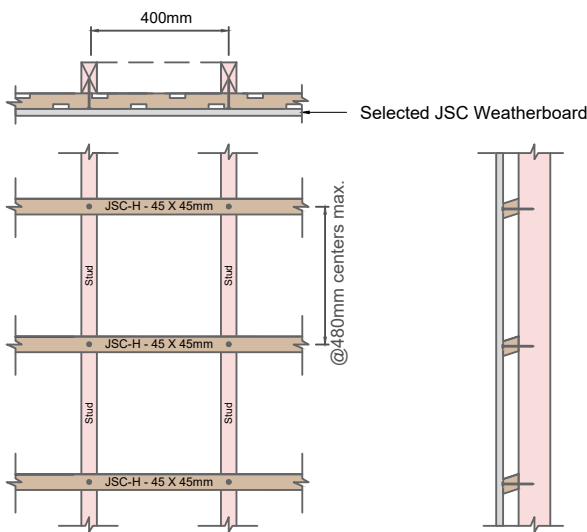

2. JSC-H 45x70mm Cavity Batten

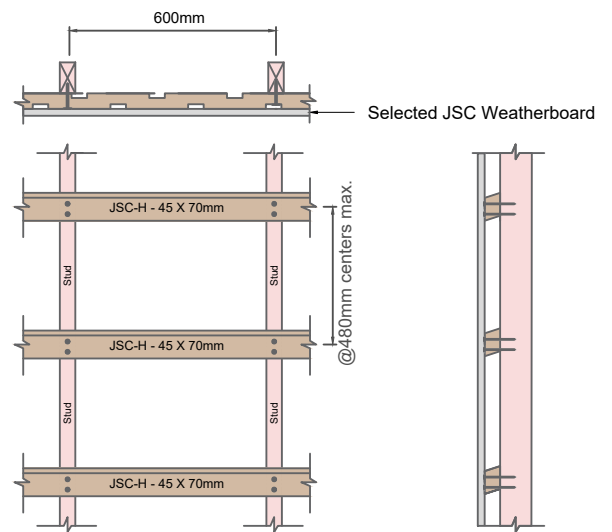

Vertical Orientation for Horizontal Weatherboard Cladding

3. JSC-V 45x45mm Cavity Batten

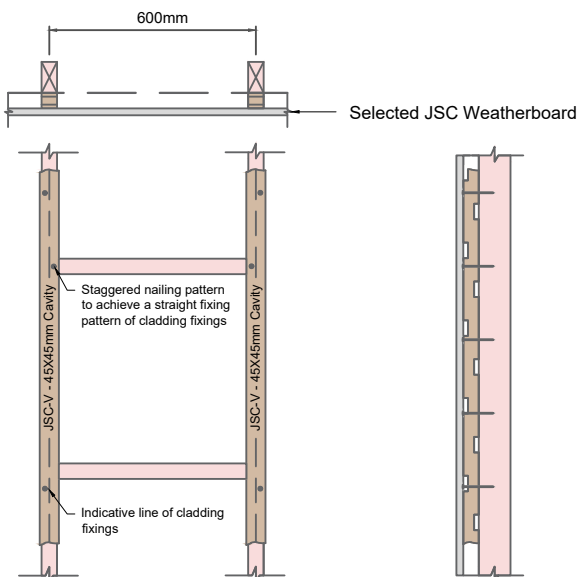

Cavity Batten Profiles

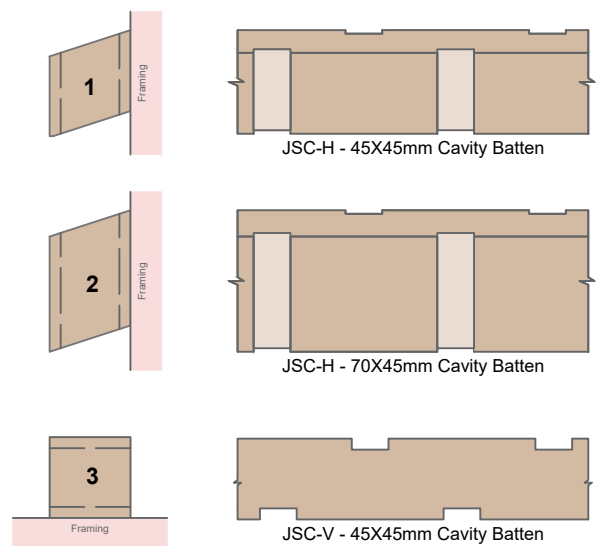

NOTES

- Cavity battens are profiled to JSC Timber specifications based on NZS 4617 and treated with H3.2 CCA or MCA (MicroPro®) as per NZS 3640.
- Wall underlay is not shown to provide more clarity.
- Framing must be fit for purpose.

JSC Timber